



Disclaimer

This user manual is provided as a free service by FixYourDLP.com. FixYourDLP is in no way responsible for the content of this manual, nor do we guarantee its accuracy. FixYourDLP does not make any claim of copyright and all copyrights remain the property of their respective owners.

About FixYourDLP.com

FixYourDLP.com (<http://www.fixyourdlp.com>) is the World's #1 resource for media product news, reviews, do-it-yourself guides, and manuals.

Informational Blog: <http://www.fixyourdlp.com>

Video Guides: <http://www.fixyourdlp.com/guides>

User Forums: <http://www.fixyourdlp.com/forum>

FixYourDLP's Fight Against Counterfeit Lamps:

<http://www.fixyourdlp.com/counterfeits>

Sponsors:

RecycleYourLamp.org – Free lamp recycling services for used lamps:

<http://www.recycleyourlamp.org>

Lamp Research - The trusted 3rd party lamp research company:

<http://www.lampresearch.com>

Discount-Merchant.com – The worlds largest lamp distributor:

<http://www.discount-merchant.com>



FixYourDLP.com

Sponsored by 

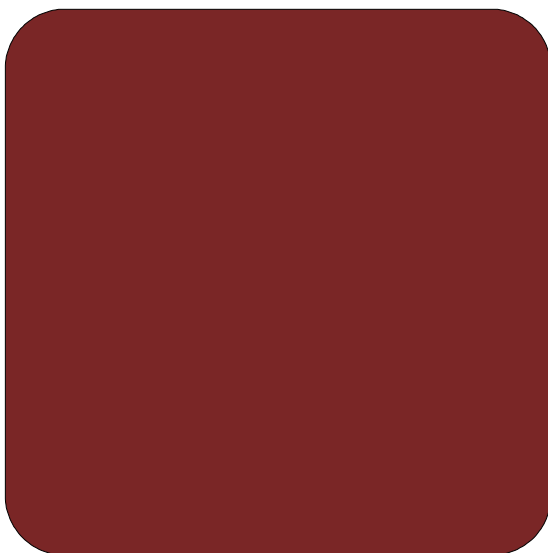

owner's manual

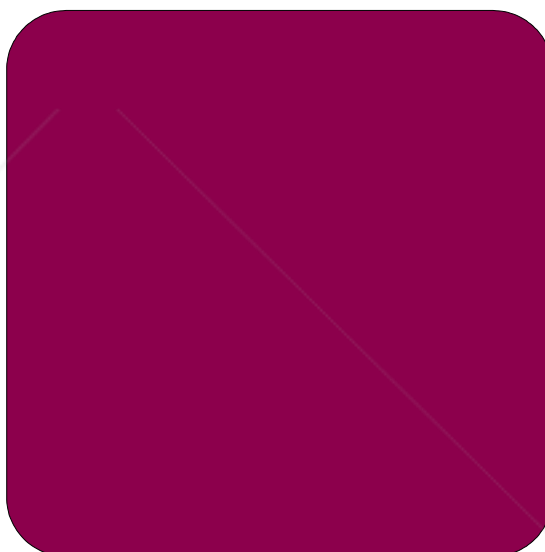

hp digital projectors
xb31 & sb21



i n v e n t

FixYourDLP.com
Sponsored by DM
Discount-Merchant.com (800) 281-8860
THE TRUSTED SOURCE FOR PROJECTOR LAMPS AND ACCESSORIES

English • version 13.05.02

owner's manual for the
hp digital projector xb31 and sb21

table of contents

safety

Personal Safety	4
Protecting Your Projector	4

introduction

Projector Features	5
Package Contents.....	6
Projector Overview	7
Control Panel.....	8
Back Panel Features	8
Remote Control With Mouse & Laser Pointer.....	9

installation

Connecting the hp digital projector xb31 to a computer	10
Connecting the hp digital projector xb31 to other signal sources	11
Connecting the hp digital projector sb21 to a computer.....	12
Connecting the hp digital projector sb21 to other signal sources	13

operation

Turning the projector ON and OFF.....	14
Turning the projector ON.....	14
Turning the projector OFF	14
Adjusting the projected image	16
Adjusting the display angle	16
Adjusting the hp xb31 zoom and focus ...	18
Projection image size (diagonal).....	18
Adjusting the hp sb21 focus	19
Projected image size (diagonal).....	19





user controls

Control panel & remote control	20
Control Panel.....	20
On-Screen Display Menus	21
How to operate.....	21
"Language" Menu	22
"All Images" Menu	23
"Audio" Menu	24
"Computer Image" Menu	25
"Management" Menu	26
"Video Image" Menu.....	27
Remote control	28

appendices

Troubleshooting	30
Changing the lamp module	32
hp xb31 specifications.....	34
hp xb31 compatibility modes	35
hp sb21 specifications.....	36
hp sb21 compatibility modes.....	37
Regulatory information.....	38
Warranty & Support	39

Personal Safety

-  **CAUTION!** PREVENT EYE INJURY. Do not look into the projector's lens when the lamp is on. Do not point the remote control's laser light at your own, or anyone else's, eyes.
-  **CAUTION!** AVOID BURN HAZARD. The lamp gets hot during normal operation. Allow it to cool down for 30 minutes before changing lamp!
-  **CAUTION!** CUT HAZARD. If the bulb is broken, use caution while removing the bulb assembly to avoid injury.
-  **CAUTION!** PREVENT ELECTRICAL SHOCK. Do not expose to rain or moisture. Do not open or disassemble projector, except as instructed by this manual.
-  **WARNING!** MERCURY HAZARD. This projector's bulb contains a small amount of mercury. If the lamp breaks, adequately ventilate the area where the breakage occurred. The projector bulb may require special handling and disposal at end-of-life.

xb31

sb21

Protecting Your Projector

Do:

- Connect projector's cables before turning the projector ON.
- Allow the projector to complete its cooling cycle after turning the Power OFF (refer to page 14).
CAUTION: Unplugging the projector while the fan is running reduces lamp life.
- Turn off and unplug the projector before cleaning.
- Use a soft, dry cloth to clean the projector's housing.
- Use camera-lens cleaning materials and procedures to clean the lens.
- Disconnect the power plug from AC outlet if the projector isn't being used for an extended period of time.
- Allow the projector to cool-down for at least 30 minutes before changing the lamp. Follow instructions provided with replacement lamp or in this manual.
- Lamp failure may produce a loud popping sound. This is normal and should not cause concern. The projector will not turn back on until the lamp module has been replaced.
- Reset the "Lamp Hour" monitor from the On Screen Display "Management" menu tab after replacing the lamp module (refer to page 26).
- Refer to page 39 for warranty and support information.

Don't:

- Unplug the projector while the fan is running.
- Block the projector's ventilation openings.
- Use abrasive cleaners, waxes, or solvents for your cleaning.
- Clean the lens with detergent.
- Use in very hot, cold, or humid environments.
- Use or store in dusty or dirty conditions.
- Use in a strong magnetic field.
- Place the projector in direct sunlight.

introduction

Projector Features

The hp digital projector xb31 is an XGA single chip 0.7" DLP™ projector with these outstanding features:

xb31

sb21

- True XGA, 1024 x 768 addressable pixels
- 1500 comparable lumens
- Approximately 3.5 lbs (1.6 kg) compact design
- Single chip DLP™ technology
- SXGA compression and VGA, SVGA re-sizing
- 156 watts (W) user-replaceable P-VIP lamp module
- NTSC3.58/NTSC4.43/PAL/PAL-M/PAL-N/SECAM and HDTV compatible
- Full function remote with mouse control and laser pointer
- High-tech VESA M1-DA connection for digital and analog video connectivity
- High definition TV (HDTV) compatibility
- User-friendly multilingual On Screen Display (OSD) menu
- Advanced electronic keystone correction
- User-friendly control panel
- Built-in 2 watt audio speaker
- Carrying case and cables included (refer to page 6)

The hp digital projector sb21 is an SVGA single chip 0.55" DLP™ projector with these outstanding features:

- True SVGA, 800 x 600 addressable pixels
- 1000 comparable lumens
- Approximately 2.2 lbs (1 kg) compact design
- Single chip DLP™ technology
- XGA compression and VGA re-sizing
- 132 watts (W) user-replaceable P-VIP lamp module
- NTSC3.58/NTSC4.43/PAL/PAL-M/PAL-N/SECAM and HDTV compatible
- Full function remote with mouse control and laser pointer
- High-tech VESA M1-DA connection for digital and analog video connectivity
- High definition TV (HDTV) compatibility
- User-friendly multilingual On Screen Display (OSD) menu
- Advanced electronic keystone correction
- User-friendly control panel
- Carrying case and cables included (refer to page 6)

Package Contents

The hp digital projectors come with the following items. Please check to make sure your unit is complete. If anything is missing contact your dealer immediately.

xb31



Projector with lens cap



Composite Video Cable



S-video Cable



Audio Cable

sb21



Projector with lens cap



2.5 mm Mini Phone Jack for Composite Video Cable



USB Mini-B 5-pin to S-video Input Cable

xb31

sb21



Carrying Case



Power Cord



Mi-A to VGA and USB Cable



Remote Control with Mouse Function and Laser Pointer



Battery x2



Owner's Manual on Compact Disc (CD ROM)



Quick Start Card

introduction

Projector Overview

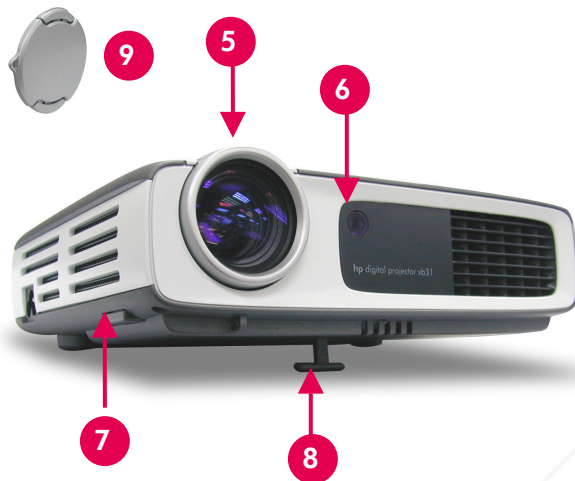

xb31

1. Control Panel
2. Power Connector
3. I/O Connection Ports
4. Zoom Ring
5. Focus Ring

6. Remote Control Receivers (front & back)
7. Elevation Button
8. Elevation Foot
9. Lens Cap

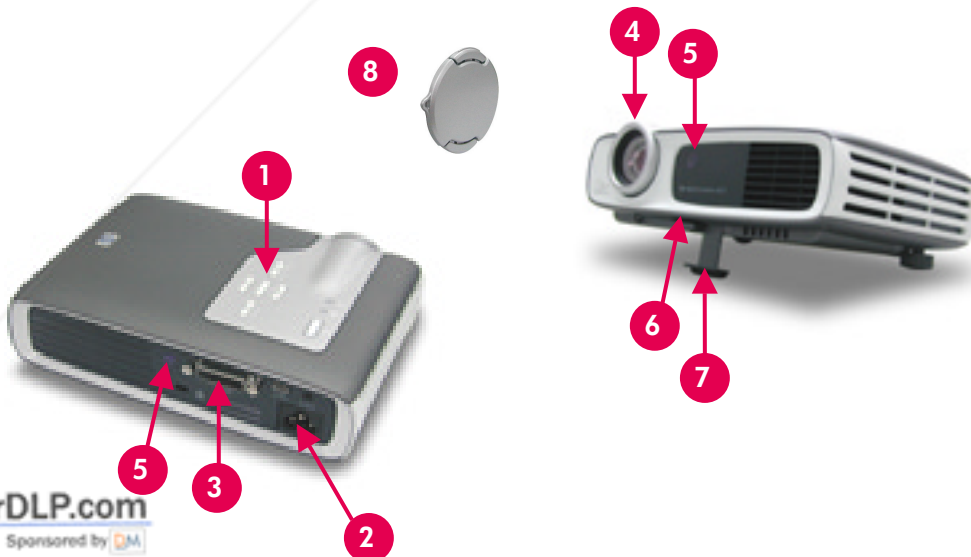

sb21

1. Control Panel
2. Power Connector
3. I/O Connection Ports
4. Focus Ring
5. Remote Control Receivers (front & back)
6. Elevation Button
7. Elevation Foot
8. Lens Cap

introduction

Control Panel

- 1. Power (ON/OFF) Button
- 2. Lamp Warning Indicator Light
- 3. Temperature Warning Indicator Light
- 4. Source Button
- 5. Menu (ON/OFF) Button
- 6. Auto Image Button
- 7. Four Directional Select Buttons

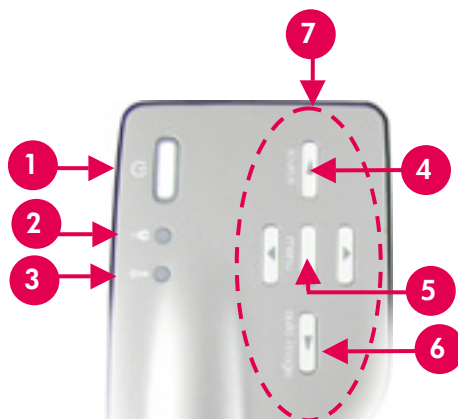

xb31

sb21

Back Panel Features

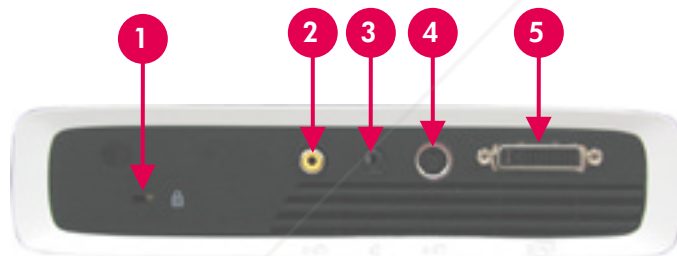

- 1. Kensington™ Lock Hole
- 2. Composite Video Input
- 3. Audio Input
- 4. S-Video Input
- 5. VESA M1-DA Analog RGB / Digital / HDTV / Component Video / USB Mouse Input

xb31

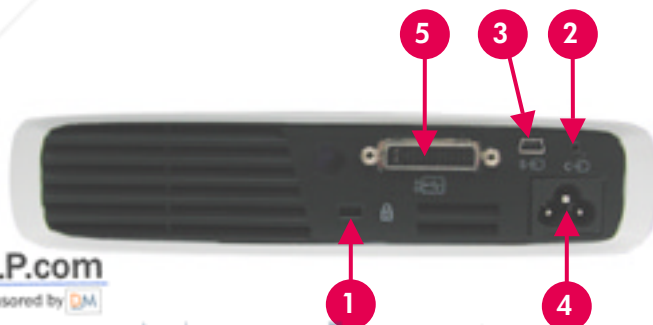

sb21



Discount-Merchant.com (800) 281-8860

- 1. Kensington™ Lock Hole
- 2. Composite Video Input
- 3. S-Video Input
- 4. Power Connector
- 5. VESA M1-DA Analog RGB / Digital / HDTV / Component Video / USB Mouse Input

introduction

Remote Control With Mouse & Laser Pointer

xb31

sb21



Left Mouse Button



CAUTION!
PREVENT EYE INJURY.

Do not point the remote control's laserlight at anyone's eyes.

NOTE: Connect the USB cable when using the remote control mouse features.

installation

xb31

Connecting the hp digital projector xb31 to a computer



Connect the power cord to the projector and a power outlet.

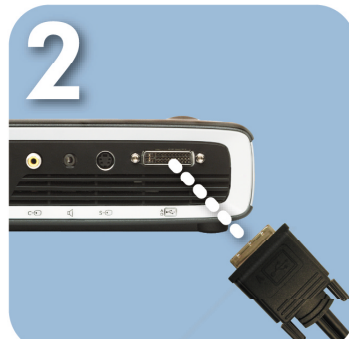

Connect the black end of the video cable to the projector.



Connect the blue end of the video cable to the PC; optionally, to have the remote control function as a mouse, connect the USB connector to the PC.



Start the projector; after a 30-second warm-up it will search for a video signal.



If no video signal is found, you may need to set up the PC to send a video signal out the video port.

CAUTION!

Unplugging the projector while the fan is running may reduce lamp life.

NOTE: For best performance, configure the display mode of your computer's graphic card to 1024x768 resolution. Ensure the timing of the display mode is compatible with the projector. Refer to the "hp xb31 compatibility modes" section on page 35.

installation

Connecting the hp digital projector xb31 to other signal sources

xb31

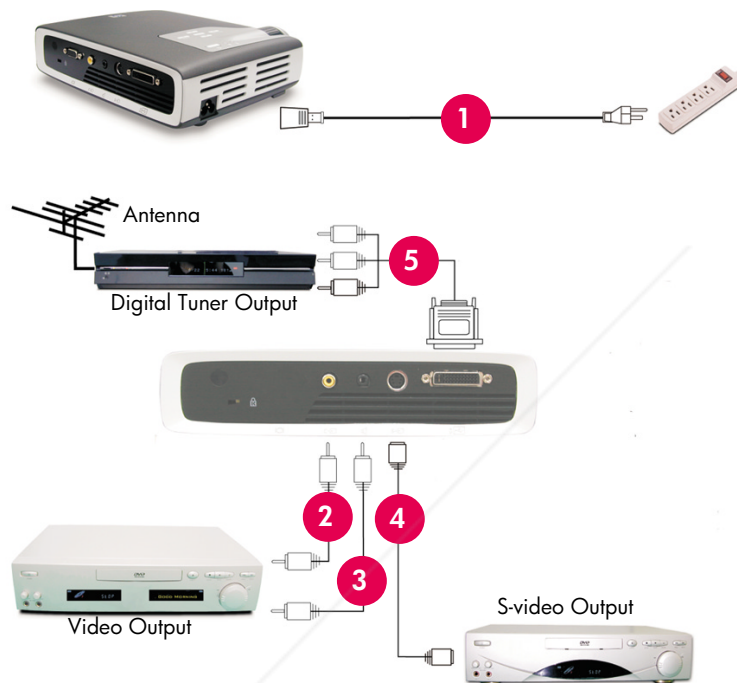

1. Power Cord
2. Composite Video Cable
3. Audio Cable
4. S-video Cable
5. M1-A to HDTV / Component and USB Cable (optional accessory)

CAUTION!

Unplugging the projector while the fan is running may reduce lamp life.

NOTE: For best performance, configure the display mode of your computer's graphic card to 1024x768 resolution. Ensure the timing of the display mode is compatible with the projector. Refer to the "hp xb31 compatibility modes" section on page 35.

installation

Connecting the hp digital projector sb21 to a computer

sb21



Connect the power cord to the projector and a power outlet.



Connect the black end of the video cable to the projector.



Connect the blue end of the video cable to the PC; optionally, to have the remote control function as a mouse, connect the USB connector to the PC.



Start the projector; after a 30-second warm-up it will search for a video signal.



If no video signal is found, you may need to set up the PC to send a video signal out the video port.

CAUTION!

Unplugging the projector while the fan is running may reduce lamp life.

NOTE: For best performance, configure the display mode of your computer's graphic card to 800x600 resolution. Ensure the timing of the display mode is compatible with the projector. Refer to the "hp sb21 compatibility modes" section on page 37.

installation

sb21

Connecting the hp digital projector sb21 to other signal sources

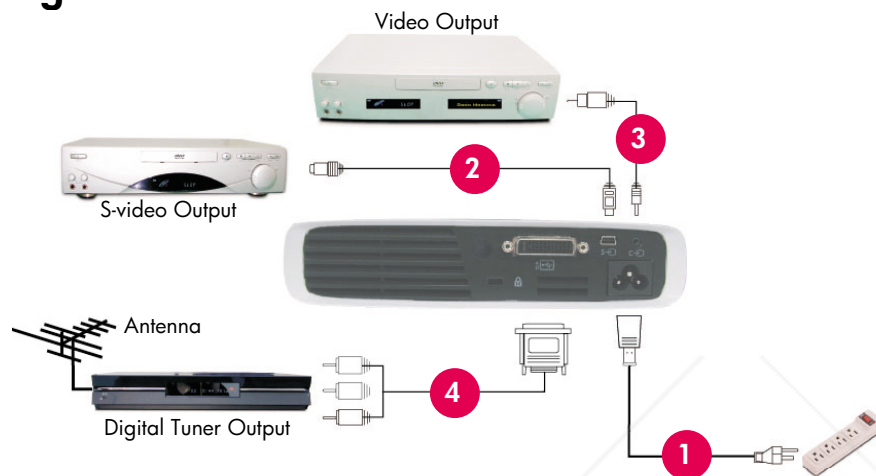

1. Power Cord
2. Composite Video Cable
3. S-video Cable
4. M1-A to HDTV / Component and USB Cable (optional accessory)

CAUTION!

Unplugging the projector while the fan is running may reduce lamp life.

NOTE: For best performance, configure the display mode of your computer's graphic card to 800×600 resolution. Ensure the timing of the display mode is compatible with the projector. Refer to the "hp sb21 compatibility modes" section on page 37.

Turning the projector ON and OFF

Turning the projector ON

xb31

sb21

1. Remove the lens cap ❶ by squeezing the cap's tabs and pulling forward.
2. Ensure that the power cord and signal cables are securely connected to the projector and the signal source (computer, notebook, video player, etc.).
3. Turn the projector ON by pressing the Power ON/OFF button on the control panel. ❷
 - The cooling fan turns on.
 - The hp start-up screen will be displayed for 30 seconds and the blue Power Indicator Light will light up.
4. Turn on your signal source. The projector will detect your source automatically.
 - If the screen displays "Waiting for Signal" make sure the signal cables are securely connected.
 - If multiple signal sources are connected, use the "Source" button on the Remote Control or Control Panel to switch to the desired input.
 - When the Lamp Indicator Light ❸ is ON, replace the lamp.
 - When the Temp Indicator Light ❹ is ON, it indicates that the projector has overheated. The projector's lamp will automatically turn OFF. Press the "Power ON/OFF" button and allow the projector to complete its cool-down cycle. Then you can restart the projector and continue your presentation. If the problem persists, contact hp support: (www.hp.com/support/digitalprojectors).
 - When the Temp Indicator Light ❹ FLASHES, the projector has detected a failure in the cooling system. Press the "Power ON/OFF" button and allow the projector to complete its cool-down cycle. Contact hp support: (www.hp.com/support/digitalprojectors).

Turning the projector OFF

1. Press the Power ON/OFF button. The projector lamp will turn off and the cooling fan will run for the duration of the cool-down cycle.
 - The blue Power Indicator Light will blink until the cool-down cycle is complete.
 - The blue Power Indicator Light will then turn OFF and the cooling fan will stop.
2. Disconnect the power cord from the electrical outlet and the projector.

operation

Turning the projector ON and OFF (continued)

xb31

sb21

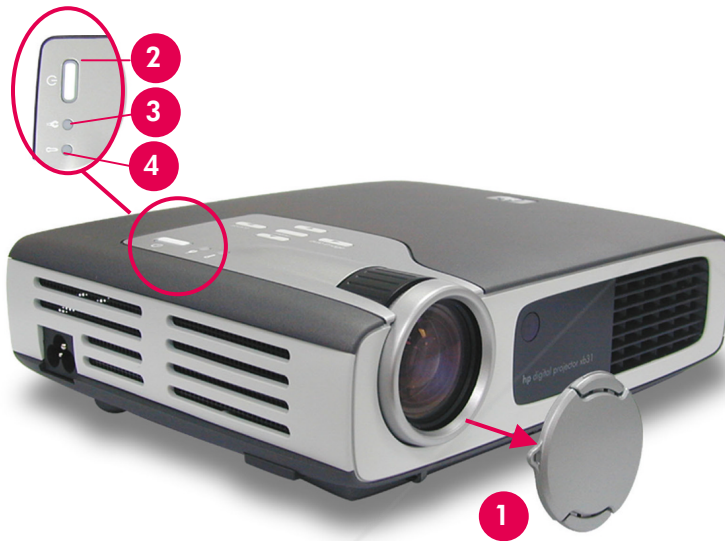

CAUTION! Unplugging the projector while the fan is running may reduce lamp life.

NOTE: Turn on the projector before turning on the signal source.

NOTE: When the blue Power Indicator Light is blinking the unit cannot be turned ON or OFF. The projector will not respond to any user input.

NOTE: The model shown is the hp xb31.

operation

xb31

sb21

Adjusting the projected image

Adjusting the display angle

To raise the projector display angle:

1. Press and hold the elevation button ❶.
2. Raise the projector to the desired display angle ❷, then release the button to lock the elevation foot into position.

To lower the projector display angle:

1. Press and hold the elevation button ❶.
2. Lower the projector, then release the button to lock the elevation foot into its retracted position.

Leveling the Projector

Use the rear elevation foot adjustment ❸ for aligning the projector to the screen.

operation

Adjusting the display angle (continued)



xb31



sb21

operation

xb31

Adjusting the hp xb31 zoom and focus

Zoom is adjusted by rotating the zoom ring.

Rotate the focus ring until the image is clear.

The projector will focus at distances from 1.14 m to 12 m (3.7 feet to 39.4 feet).

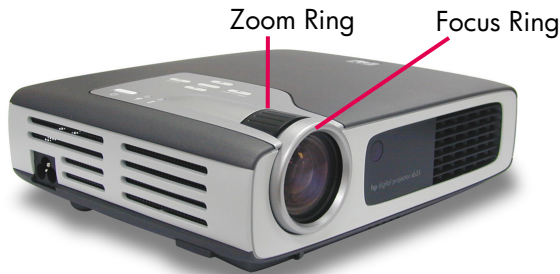

Projected image size (diagonal)

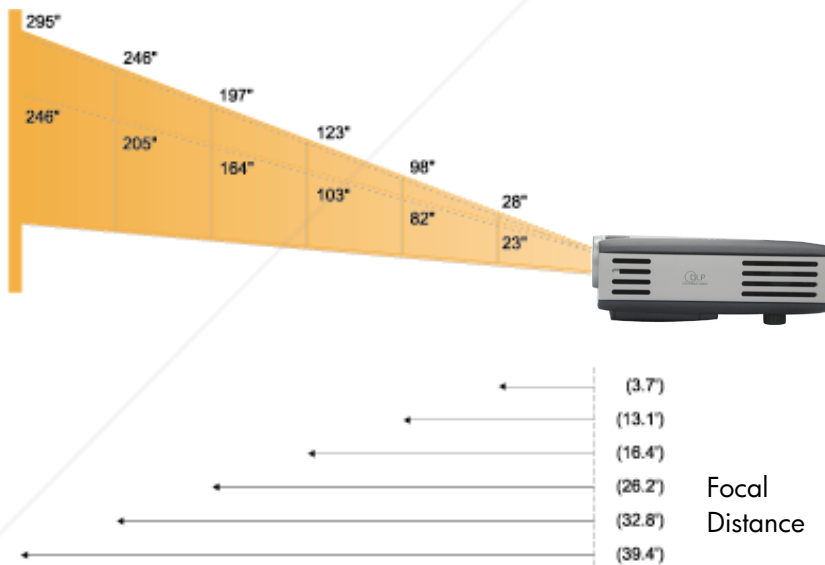

Calculating the Projected Image Size

The screen diagonal dimension can be approximated by using one of these formulas:

Zoomed out

$$7.5 * \text{Distance(ft.)} = \text{Diagonal(in.)}$$

$$0.625 * \text{Distance(m)} = \text{Diagonal(m)}$$

or

Zoomed in

$$6.25 * \text{Distance(ft.)} = \text{Diagonal(in.)}$$

$$0.52 * \text{Distance(m)} = \text{Diagonal(m)}$$

For example:

If your xb31 is 10 feet from the screen, the approximate zoomed out screen diagonal dimension will be $7.5 * 10 = 75$ inches.

Screen (Diagonal)	Max.	28"	98"	123"	197"	246"	295"
	Min.	23"	82"	103"	164"	205"	246"
Screen Size	Max.(WxH)	22.4"x16.8"	78.4"x58.8"	98.4"x73.8"	157.6"x118.2"	196.8"x147.6"	236.0"x177.0"
	Min.(WxH)	18.4"x13.8"	65.6"x49.2"	82.4"x61.8"	131.2"x98.4"	164.0"x123.0"	196.8"x147.6"
Focal Distance		3.7'	13.1'	16.4'	26.2'	32.8'	39.4'

NOTE: This graph is for user's reference only.

operation

sb21

Adjusting the hp sb21 focus

Rotate the focus ring until the image is clear.
The projector will focus at distances from 1.0 m to 12 m (3.3 feet to 39.4 feet).



Projected image size (diagonal)

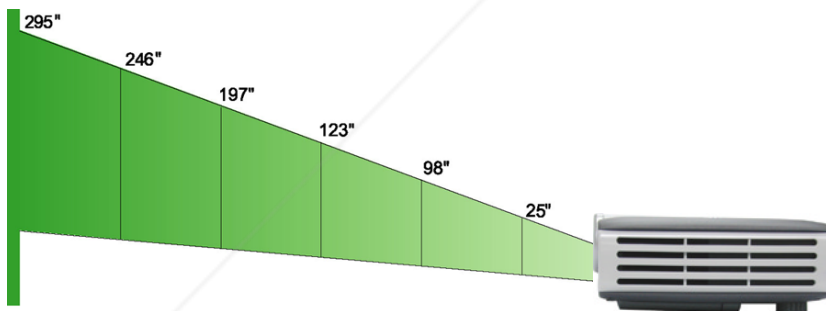

Calculating the Projected Image Size

The screen diagonal dimension can be approximated by using one of these formulas:

$$7.5 * \text{Distance(ft.)} = \text{Diagonal(in.)}$$

$$0.625 * \text{Distance(m)} = \text{Diagonal(m)}$$

For example:

If your sb21 is 10 feet from the screen, the approximate screen diagonal dimension will be $7.5 * 10 = 75$ inches.

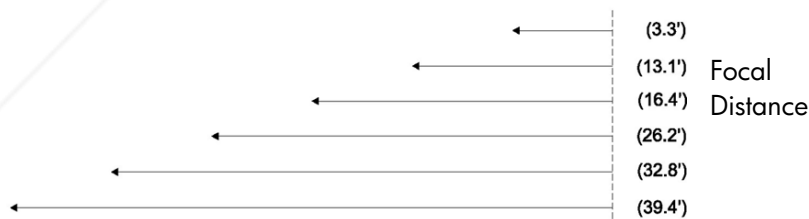

Screen (Diagonal)	25"	98"	123"	197"	246"	295"
Screen Size (wxh)	20.0"x15.0"	78.4"x58.6"	98.4"x73.8"	157.6"x118.2"	196.8"x147.6"	236.2"x177.2"
Focal Distance	3.3'	13.1'	16.4'	26.2'	32.8'	39.4'

NOTE: This graph is for user's reference only.

user controls

Control panel & remote control

xb31

sb21

The projector's functions are controlled via the Control Panel and the Remote Control, and the On Screen Display (OSD).

Control Panel



1. Power (ON/OFF) Button
2. Lamp Warning Indicator Light
3. Temperature Warning Indicator Light
4. Source Button
5. Menu (ON/OFF) Button
6. Auto Image Button
7. Four Directional Select Buttons

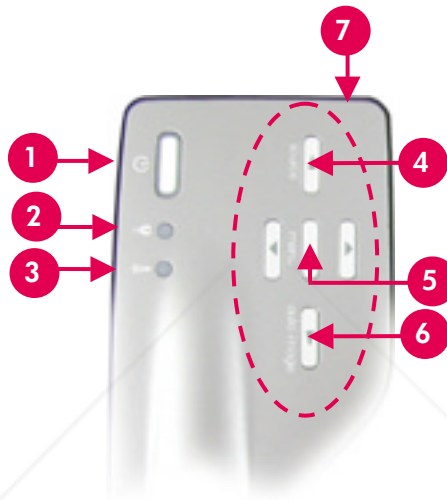

Power ON/OFF Button

- Refer to "Turning the Projector ON and OFF" on pages 14-15.

Source Button

- Press the "Source" button to choose the appropriate signal source - RGB, DVI-Digital, DVI-Analog, S-Video, Composite, Component and HDTV sources.

NOTE: This button will not function when the OSD menu is displayed.

Auto Image Button

- Press the "Auto Image" button to automatically synchronize the projector to the input source.

NOTE: This button will not function when the OSD menu is displayed.

user controls

On Screen Display Menus

The projector has multilingual On Screen Display (OSD) menus that allow you to make image adjustments by changing a variety of settings.

xb31

sb21

How to operate

- Press the "Menu" button on the Remote Control or Control Panel to open the OSD.
- Press the ◀ ▶ buttons to display the contents of the desired menu tab. The selected tab's title will change from dark blue to white.
- Press the ▲ ▼ buttons to select the desired menu item. When an item is selected, the color of the item will change from light blue text on a dark blue background to white text on an orange background. Adjust the settings with the ◀ ▶ buttons.
- Press the ▲ button until no menu items are highlighted. Then either -
Press the ◀ ▶ buttons to display the contents of additional Menu tabs
or
Press the "Menu" button. The OSD menu will close and the projector will automatically save the new settings.

user controls

xb31

sb21

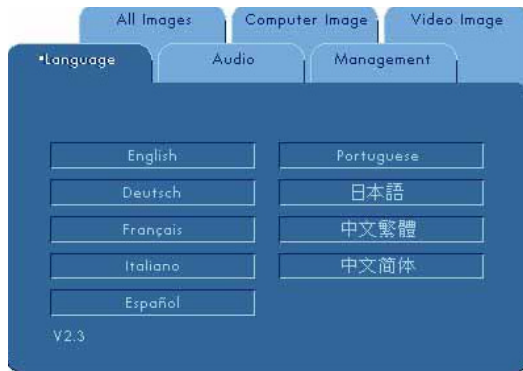

“Language” Menu

To open the “Language” menu:

1. Press the “Menu” button to open the On Screen Display (OSD) menus.
2. Use the ◀ or ▶ buttons to open the “Language” menu tab.
3. Press the ▲ ▼ buttons to select the desired language.
4. Press the “Menu” button to finalize the selection.

NOTE: The hp sb21’s OSD does not include an Audio menu.

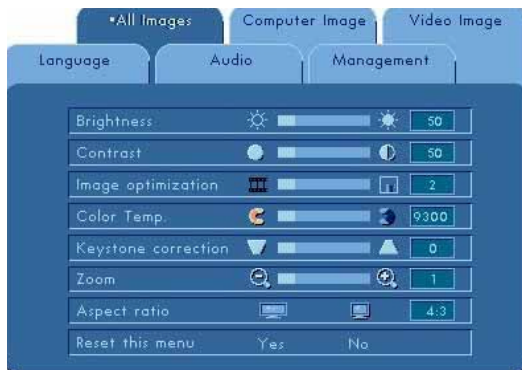

**user
controls**

xb31

sb21

“All Images” Menu

To open the “All Images” menu:

1. Press the “Menu” button to open the On Screen Display (OSD) menus.
2. Use the ◀ or ▶ buttons to open the “All Images” menu tab.
3. Press the ▲ ▼ buttons to select one of the following items:

Brightness

- Press the ◀ button to darken the image.
- Press the ▶ button to lighten the image.

Contrast

The contrast controls the degree of difference between the lightest and darkest parts of the picture.

- Press the ◀ button to decrease the contrast.
- Press the ▶ button to increase the contrast.

Image Optimization

Image Optimization can be incrementally adjusted between 0 and 10. Click on the slider bar to adjust.

- Setting 10 will maximize brightness and contrast
- Setting 0 will maximize color reproduction quality

Color Temp

With the higher temperature, the image looks colder. With the lower temperature, the image looks warmer.

- Press the ◀ ▶ button to decrease or increase the color temperature.

Keystone (Keystone Correction)

Corrects image distortion caused by the projector’s elevation angle. (±16 degrees)

Zoom

- Press the ▶ button to magnify an image up to 9 times.
- Press the ◀ button to reduce the image magnification.

Aspect Ratio

Aspect ratio type can be adjusted to 4:3 or 16:9.

Reset this menu

Choose “Yes” to return the display parameters on this menu to their factory default settings.

NOTE: The hp sb21’s OSD does not include an Audio menu.

user controls

xb31

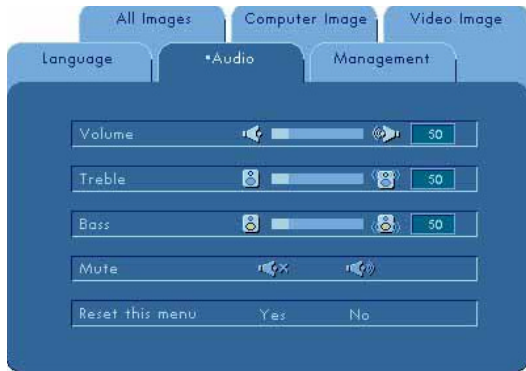

“Audio” Menu

To open the “Audio” menu:

1. Press the “Menu” button to open the On Screen Display (OSD) menus.
2. Use the ◀ or ▶ buttons to open the “Audio” menu tab.
3. Press the ▲ ▼ buttons to select one of the following items:

Volume

- Press the ◀ button to decrease the volume.
- Press the ▶ button to increase the volume.

Treble

The treble setting controls the higher frequencies of your audio source.

- Press the ◀ button to decrease the treble.
- Press the ▶ button to increase the treble.

Bass

The Bass setting controls the lower frequencies of your audio source.

- Press the ◀ button to decrease the bass.
- Press the ▶ button to increase the bass.

Mute

- Choose the left icon to mute the projector’s speaker.
- Choose the right icon to activate the projector’s speaker.

Reset this menu

Choose “Yes” to return the audio parameters of this menu to their factory default settings.

NOTE: The hp sb21’s OSD does not include an Audio menu.

user controls

xb31

sb21

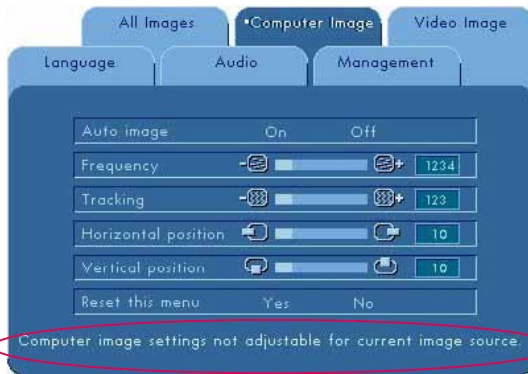

NOTE: This message is displayed when an image source other than computer VGA is selected via the **Source** button or the auto detection function.

The "Computer Image" parameters cannot be adjusted when this message is displayed.

"Computer Image" Menu

To open the "Computer Image" menu:

1. Press the "Menu" button to open the On Screen Display (OSD) menus.
2. Use the ◀ or ▶ buttons to open the "Computer Image" menu tab.
3. Press the ▲ ▼ buttons to select one of the following items:

Auto Image

The projector automatically adjusts frequency, tracking, horizontal and vertical position. With most signal sources, Auto Image provides the best results.

Frequency

"Frequency" is the display data frequency. This should match the frequency of your computer's graphic card. When you experience a vertical flickering bar, use this function to make adjustments.

Tracking

Choose "Tracking" to synchronize the signal timing of the display with that of the graphic card. When you experience an unstable or flickering image, use this function to correct it.

Horizontal Position

- Press the ◀ button to move the image left.
- Press the ▶ button to move the image right.

Vertical Position

- Press the ▲ button to move the image up.
- Press the ▼ button to move the image down.

Reset this menu

Choose "Yes" to return the display parameters of this menu to their factory default settings.

NOTE: The hp sb21's OSD does not include an Audio menu.



**user
controls**

xb31

sb21

“Management” Menu

To open the “Management” menu:

1. Press the “Menu” button to open the On Screen Display (OSD) menus.
2. Use the or buttons to open the “Management” menu tab.
3. Press the buttons to select one of the following items:

Menu Location

Choose the Menu location on the display screen.

Projection Direction

- Front-Desktop: The image used in standard desktop operation.
- Rear-Desktop: The image is reversed for projection from behind a translucent screen.
- Front-Ceiling: The image is turned upside down for ceiling-mounted projection.
- Rear-Ceiling: The image is reversed and turned upside down for ceiling-mounted projection from behind a translucent screen.

NOTE: The hp sb21’s OSD does not include an Audio menu.

Signal Type

Select the desired signal type - RGB, YCrCb and YPrPb sources.

Lamp Hour

Displays the lamp’s elapsed operating time (in hours).

Reset Lamp Hours

Reset the lamp setting only when the lamp is replaced.

Reset this Menu

Choose “Yes” to return the display parameters (except for Lamp Hours) on this menu to their factory default settings.

Machine Reset

Choose “Yes” to return the display parameters (except for Lamp Hours) on ALL menus to their factory default settings.

user controls

xb31

sb21

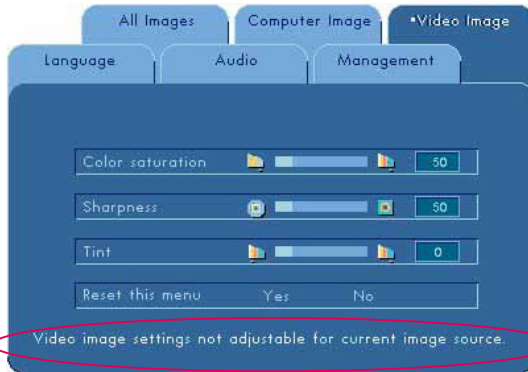

NOTE: This message is displayed when these settings cannot be adjusted for the image source selected via the **Source** button or the auto detection function (i.e. computer VGA or 480p).

The "Video Image" parameters cannot be adjusted when this message is displayed.

"Video Image" Menu

xb31

sb21

To open the "Video Image" menu:

1. Press the "Menu" button to open the On Screen Display (OSD) menus.
2. Use the ◀ or ▶ buttons to open the "Video Image" menu tab.
3. Press the ▲ ▼ buttons to select one of the following items:

Color Saturation

The color setting adjusts a video image from black and white to fully saturated color.

- Press the ◀ button to decrease the amount of color in the image.
- Press the ▶ button to increase the amount of color in the image.

Sharpness

Adjusting the sharpness of the image.

- Press the ◀ button to decrease the sharpness.
- Press the ▶ button to increase the sharpness.

Tint

The tint adjusts the color balance of red and green.

- Press the ◀ button to increase the amount of green in the image.
- Press the ▶ button to increase the amount of red in the image.

Reset this menu

Choose "Yes" to return the display parameters of this menu to their factory default settings.

NOTE: The hp sb21's OSD does not include an Audio menu.

user controls

xb31

sb21

Remote control

Power ON/OFF Button

- Refer to "Turning the Projector ON and OFF" on pages 14 and 15.

"Hide" Button

- Press the "Hide" button to project a black screen. Press the "Hide" button again to view the image.

Multi-Directional Selector Controller *

- This feature can be used as a mouse to control direction.

Right Mouse Button *

Page Up (up) and Page Down (dn) Buttons *

- Press the "up" or "dn" buttons to page up or page down, respectively.

Laser Pointer Button

- Press and hold the "Laser Pointer" button to activate the laser pointer.

Menu Button

- Press the "Menu" button to open the On Screen Display (OSD) menu and press the ◀ ▶ buttons to select the desired menu tabs. Press the ▼ button to go into the desired option's sub-menu. Press the ▲ button to return to main menu. To exit the OSD mode, press the "Menu" button again. The projector will automatically save any changes you have made.

Source Button

- Press the "Source" button to choose RGB, DVI-Digital, DVI-Analog, S-Video, Composite, Component and HDTV sources.

Freeze Button

- Press the "Freeze" button to freeze the screen image.

Volume Up (+) and Volume Down (-) Buttons (hp xb31 only)

- Press the "Volume +" or "Volume -" buttons to increase or decrease speaker volume.

Keystone Correction Buttons

- Press the "Keystone Correction" buttons to adjust image distortion caused by tilting the projector. (± 16 degrees)

NOTE: Keystone Correction can cause distortion of text and graphics.

Zoom In and Zoom Out Buttons

- When you press the "Zoom" buttons, the zoom icon appears on the screen. Press the ◀ ▶ or ▲ ▼ buttons to zoom in or zoom out.
- The image can be magnified up to 9 times.

Left Mouse Button *

- The left mouse button is located on the back of the remote control.

* To enable this function, the projector must be connected to the computer via the USB cable.



user controls

xb31

sb21



Left Mouse Button



CAUTION!
PREVENT EYE INJURY.
Do not point the remote control's laserlight at anyone's eyes.

NOTE: Connect the USB cable when using the remote control mouse features.

Troubleshooting

Consult this section if you are experiencing trouble with your projector. If the problem persists, please contact hp. Refer to Warranty and Support Information on page 39.

xb31

sb21

Problem: No image is projected on screen.

- Verify that the projector's power cord is plugged in and properly connected.
- Verify that all cables are properly installed and securely connected.
- Make sure you have removed the lens cap and that the blue Power Indicator Light is ON.
- Verify that the Lamp Indicator Light is OFF. If the Lamp Indicator Light is ON, the lamp module must be replaced. Refer to page 32 for the lamp module replacement procedure.
- Verify that the Temp Indicator Light is OFF. If it is ON, refer to page 14.
- If you are using a notebook computer, you may need to activate the external monitor port. Please consult the computer's manual for instructions. Key sequences for many computers are printed in your quick start guide.
- Check for damaged connector pins.
- Check that the projector's lamp hasn't burned out or been installed incorrectly.

Problem: Partial, scrolling or incorrectly displayed image.

- Press the "Auto Image" button on the projector or use the "Auto Image" function in the "Computer Image" menu of the On Screen Display (OSD).
- If you are using a computer:
If the resolution of your computer is higher than 1024×768 for the hp xb31 or 800×600 for the hp sb21, the projector will re-size the image to match the output of the computer. If desired, you may reset your computer's display resolution to match these by following the steps provided in your computer's owner's manual. You may have to disable the computer's monitor to correctly display the new resolution.
- Switch the notebook's display to the "external display only" or "CRT only" mode following the instructions provided in your computer's owner's manual.
- If you experience difficulty in changing the resolution settings, or your monitor freezes, restart the computer and the projector.

Problem: The notebook's screen is not displaying your presentation.

Some notebook PCs may deactivate their own screen when a second display device is in use. Refer to your computer's documentation for information. If you are using a notebook computer, you may need to activate the external monitor port. Please consult the computer's manual for instructions. Key sequences for many computers are printed in your quick start guide.

Troubleshooting (continued)

- If you are using an Apple PowerBook™:
In Control Panels, open the PowerBook Display to select Video Mirroring "On."

Problem: Image is unstable or flickering

- Activate the "Auto Image" function.
- Adjust the "Tracking" variable in the "Computer Image" tab of the On Screen Display (OSD). Refer to page 25.
- Change the color settings of the computer's monitor (see page 27).

Problem: Image has vertical flickering bar

- Activate the "Auto Image" function.
- Adjust the "Frequency" variable in the "Computer Image" tab of the OSD (refer to page 25).
- Check and re-configure the display mode of your graphic card to make it compatible with the product (refer to pages 25, 35 and 37).

Problem: Image is out of focus

- Focus the image with the projector's Focus Ring.
- Make sure the projection screen is located approximately 1.0 m (3.3 feet)~ 12 m (39.4 feet) from the projector.

Problem: The image is stretched when displaying 16:9 DVD.

The projector will automatically detect a 16:9 DVD source signal and adjust the aspect ratio to produce a full, 4:3-aspect-ratio screen display. If the projected image is distorted, adjust the aspect ratio by doing the following:

- Select 4:3 aspect ratio type on your DVD player if you are playing a 16:9 DVD.
- If you cannot select 4:3 aspect ratio type on your DVD player, select 4:3 for the "Aspect Ratio" variable in the "All Images" tab of the OSD (refer to page 23).

Problem: Image is reversed

- Change the "Projection Direction" parameter in the "Management" tab of the OSD (refer to page 26).

Problem: Burned out Lamp

- When the lamp module burns out it may make a loud popping sound. The projector will not turn back on until the lamp module has been replaced. Follow the lamp change procedure presented in this manual (page 30) and included with the replacement lamp.
- Remember to reset the "Lamp Hour" counter from the On Screen Display (OSD) "Management" menu tab after replacing the lamp (refer to page 26).

NOTE: Some notebook computers running NT 4.0 have difficulty sending a signal to an external display.

Changing the lamp module

Your projector will monitor the lamp's elapsed operating time, or "lamp hours." After 1000 lamp hours, the projector will display the following message at start-up:

"The lamp has been in use for over 1000 hours.
You may consider purchasing a spare bulb."

After 1500 lamp hours, the projector will display the following message at start-up:

"The lamp has been in use for over 1500 hours.
You should purchase a spare bulb."

NOTE: The projector's bulb contains mercury. It may require special handling at end-of-life.

Procedure:

1. If the projector has been in use -
 - Turn the power OFF by pressing the Power ON/OFF button.
 - Allow the projector to cool down for at least 30 minutes.
 - Disconnect the power cord.
2. Use screwdriver to remove the two screws from the cover. ❶
3. Remove the cover. ❷
4. xb31: Remove the two screws from the lamp module. ❸
sb21: Remove the three screws from the lamp module. ❸
5. Use the lamp module's hinged handle to remove the lamp module. ❹
Reverse these steps to install the replacement lamp module. ❺
6. Insure that the lamp module door is securely attached and flush with the unit. The unit will not operate with the door incorrectly installed.
7. Reset the "Lamp Hour" monitor from the On Screen Display (OSD) "Management" menu tab (refer to page 26).

NOTE: If lamp module door is not securely fastened the lamp will not function.

CAUTION! AVOID BURN HAZARD.

The lamp gets hot during normal operation. Allow it to cool down for 30 minutes before changing lamp!

CAUTION! CUT HAZARD.

If the bulb is broken, use caution to avoid injury.

WARNING!

MERCURY HAZARD. This projector's bulb contains a small amount of mercury. If the lamp breaks, adequately ventilate the area where the breakage occurred. The projector bulb may require special handling and disposal at end-of-life.

Changing the lamp module (continued)

NOTE: For both the xb31 and the sb21 digital projectors, a Phillips-head screwdriver is required for this procedure.

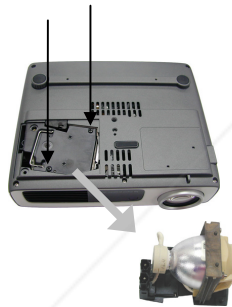
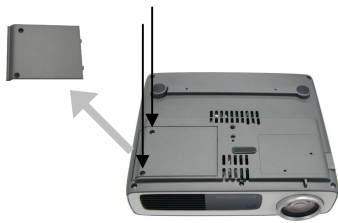

xb31

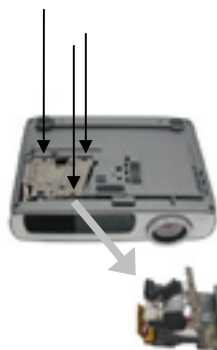
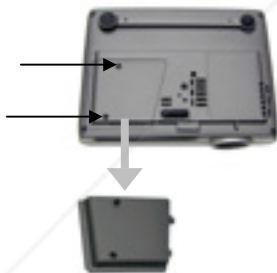

sb21

hp xb31 specifications

xb31

- Light Engine • Single Chip DLP™ Technology
- Brightness • 1500 comparable lumens
- Contrast Ratio • 1800:1 (Full On/Full Off)
- Lamp • 156 watt (W) user-replaceable P-VIP Lamp Module
- Number of Pixels • 1024 (H)×768 (V)
- Displayable Colors • 16.7 million
- Projection Lens • F/2.44~2.69, f=28.8~34.5 mm with optical 1.2:1 zoom and manual focus
- Projection Screen Size • 0.7~7.5 m (28~295 inches) Diagonal
- Projection Distance • 1.14~12 m (3.7~39.4 feet)
- Video Compatibility • NTSC 3.58/NTSC 4.43/PAL/PAL-M/PAL-N/SECAM and HDTV compatible
- Composite video, S-video, and component video (via optional cable)
- H. Frequency • 15 kHz~100 kHz horizontal scan rate
- V. Frequency • 43 Hz~120 Hz vertical refresh rate
- Power Supply • Universal AC input 100~240V;
Input Frequency 50/60 Hz
- Power Consumption • 220 watts
- Uniformity • 85% (JBMA)
- I/O Connectors • Power: AC power input socket
- Computer Input:
 - One 35-pin VESA M1-DA for Analog RGB/Digital/Component Video/HDTV/USB mouse
- Video Input:
 - One Composite Video RCA input
 - One S-video input
- Audio Input:
 - One phone jack for mono audio input
- Weight • 1.6 kg (3.5 pounds)
- Dimensions (W×H×D) • 226×183×67 mm (8.92×7.23×2.67 inches)
- Environmental • Operating Temperature:

Operating Temperature (°C)	Altitude (ft)
10-40	0 ~ 2,500
10-35	2,500 ~ 5,000
10-30	5,000 ~ 7,000
10-28	7,000 ~ 10,000

- Storage Temperature: -20° C~60° C (-4° F~140° F) at 80% maximum humidity (0~40,000 ft)

Safety Regulation See page 38 for regulatory information

appendices

hp xb31 compatibility modes

xb31

Mode	Resolution	ANALOG		DIGITAL	
		V.Frequency (Hz)	H.Frequency (Hz)	V.Frequency (Hz)	H.Frequency (Hz)
VESA VGA	640 x 350	70	31.5	70	31.5
VESA VGA	640 x 350	85	37.9	85	37.9
VESA VGA	640 x 400	85	37.9	85	37.9
VESA VGA	640 x 480	60	31.5	60	31.5
VESA VGA	640 x 480	72	37.9	72	37.9
VESA VGA	640 x 480	75	37.5	75	37.5
VESA VGA	640 x 480	85	43.3	85	43.3
VESA VGA	720 x 400	70	31.5	70	31.5
VESA VGA	720 x 400	85	37.9	85	37.9
SVGA	800 x 600	56	35.2	56	35.2
SVGA	800 x 600	60	37.9	60	37.9
SVGA	800 x 600	72	48.1	72	48.1
SVGA	800 x 600	75	46.9	75	46.9
SVGA	800 x 600	85	53.7	85	53.7
VESA XGA	1024 x 768	43.4	35.5	43.4	35.5
VESA XGA	1024 x 768	60	48.4	60	48.4
VESA XGA	1024 x 768	70	56.5	70	56.5
VESA XGA	1024 x 768	75	60.0	75	60.0
VESA XGA	1024 x 768	85	68.7	-	-
* VESA SXGA	1280 x 1024	60	63.95	-	-
* VESA SXGA	1280 x 1024	75	79.98	-	-
MAC LC13"	640 x 480	66.66	34.98	-	-
MAC II 13"	640 x 480	66.68	35	-	-
MAC 16"	832 x 624	74.55	49.725	-	-
MAC 19"	1024 x 768	75	60.24	-	-
* MAC	1152 x 870	75.06	68.68	-	-
MAC G4	640 x 480	60	31.35	-	-
MAC G4	640 x 480	120	68.03	-	-
MAC G4	1024 x 768	120	97.09	-	-
I MAC DV	640 x 480	117	60	-	-
I MAC DV	800 x 600	95	60	-	-
I MAC DV	1024 x 768	75	60	-	-
* I MAC DV	1152 x 870	75	68.49	-	-
* I MAC DV	1280 x 960	75	75	-	-
* I MAC DV	1280 x 1024	75	90.9	-	-

NOTE: These projectors are compatible with the following computer operating systems: Windows 98/ME/2000/XP, MAC OS 9.0 and 10.0.

NOTE: Some notebook computers running NT 4.0 have difficulty sending a signal to an external display.

hp sb21 specifications

- Light Engine • Single Chip DLP™ Technology
- Brightness • 1000 comparable lumens
- Contrast Ratio • 1800:1 (Full On / Full Off)
- Lamp • 132 watt (W) user-replaceable P-VIP Lamp Module
- Number of Pixels • 800 (H)×600 (V)
- Displayable Colors • 16.7 million
- Projection Lens • F/2.4, f=22.4 mm with manual focus
- Projection Screen Size • 0.6~7.5 m (25~295 inch) diagonal
- Projection Distance • 1m~12 m (3.3~39.4 ft)
- Video Compatibility • NTSC3.58/NTSC4.43/PAL/PAL-M/PAL-N/SECAM and HDTV compatible
- Composite video, S-video capability, Component video (via optional cable)
- H. Frequency • 15 kHz~70 kHz horizontal scan rate
- V. Frequency • 43 Hz~85 Hz vertical refresh rate
- Power Supply • Universal AC input 100~240V ; Input Frequency 50/60 Hz
- Power Consumption • 160 watts
- Uniformity • 85% (JBMA)
- I/O Connectors • Power: AC power input socket
- Computer Input:
 - One 35-pin VESA M1-DA for Analog RGB/Digital /Component Video/HDTV/USB mouse
- Video Input:
 - One 2.5mm phone jack for Composite video input
 - One USB Mini-B 5-pin for S-video input
- Weight • 1 kg (2.2 pounds)
- Dimensions (W×H×D) • 200×141×60 mm (7.90×5.55×2.30 inches)
- Environmental • Operating Temperature:

Operating Temperature (°C)	Altitude (ft)
10-40	0 ~ 2,500
10-35	2,500 ~ 5,000
10-30	5,000 ~ 7,000
10-28	7,000 ~ 10,000

- Storage Temperature: -20° C~60° C (-4° F~140° F) at 80% maximum humidity (0~40,000 ft)

See page 38 for regulatory information

appendices

hp sb21 compatibility modes

sb21

Mode	Resolution	ANALOG		DIGITAL	
		V.Frequency (Hz)	H.Frequency (Hz)	V.Frequency (Hz)	H.Frequency (Hz)
VESA VGA	640 x 350	70	31.5	70	31.5
VESA VGA	640 x 350	85	37.9	85	37.9
VESA VGA	640 x 400	85	37.9	85	37.9
VESA VGA	640 x 480	60	31.5	60	31.5
VESA VGA	640 x 480	72	37.9	72	37.9
VESA VGA	640 x 480	75	37.5	75	37.5
VESA VGA	640 x 480	85	43.3	85	43.3
VESA VGA	720 x 400	70	31.5	70	31.5
VESA VGA	720 x 400	85	37.9	85	37.9
SVGA	800 x 600	56	35.2	56	35.2
SVGA	800 x 600	60	37.9	60	37.9
SVGA	800 x 600	72	48.1	72	48.1
SVGA	800 x 600	75	46.9	75	46.9
SVGA	800 x 600	85	53.7	85	53.7
* VESA XGA	1024 x 768	43.4	35.5	43.4	35.5
* VESA XGA	1024 x 768	60	48.4	60	48.4
* VESA XGA	1024 x 768	70	56.5	70	56.5
* VESA XGA	1024 x 768	75	60.0	75	60.0
* VESA XGA	1024 x 768	85	68.7	-	-
MAC LC13"	640 x 480	66.66	34.98	-	-
MAC II 13"	640 x 480	66.68	35	-	-
* MAC 16"	832 x 624	74.55	49.725	-	-
* MAC 19"	1024 x 768	75	60.24	-	-
MAC G4	640 x 480	60	31.35	-	-
* I MAC DV	1024 x 768	75	60	-	-

"*" compressed computer image

NOTE: These projectors are compatible with the following computer operating systems: Windows 98/ME/2000/XP, MAC OS 9.0 and 10.0.

NOTE: Some notebook computers running NT 4.0 have difficulty sending a signal to an external display.

regulatory information

Regulatory information

This section presents information that shows how your digital projector complies with regulations in certain regions. Any modifications to your digital projector not expressly approved by Hewlett-Packard could void the authority to operate the digital projector in these regions.

U.S.A.

This digital projector has been tested and found to comply with the limits for a Class B digital device, pursuant to Part 15 of the FCC Rules. These limits are designed to provide reasonable protection against harmful interference in a residential installation.

This digital projector generates, uses, and can radiate radio frequency energy. If not installed and used in accordance with the instructions, it may cause harmful interference to radio communications. However, there is no guarantee that interference will not occur in a particular installation. If this digital projector does cause harmful interference to radio or television reception (which can be determined by unplugging the unit), try the following:

- Reorienting or relocating the receiving antenna.
- Relocating the digital projector with respect to the receiver.
- Connecting the digital projector's power cord to another power outlet.

Connections to Peripheral Devices

To maintain compliance with FCC Rules and Regulations, use properly shielded cables with this device.

For more information, consult your dealer, an experienced radio/television technician, or the following booklet, prepared by the Federal Communications Commission: *How to Identify and Resolve Radio-TV Interference Problems*. This booklet is available from the U.S. Government Printing Office, Washington, DC 20402, Stock Number 004-000-00345-4. At the first printing of this manual, the telephone number was (202) 512-1800.

Japanese Notice

この装置は、情報処理装置等電波障害自主規制協議会（VCCI）の基準に基づくクラスB情報技術装置です。この装置は、家庭環境で使用することを目的としていますが、この装置がラジオやテレビジョン受信機に近接して使用されると、受信障害を引き起こすことがあります。

取扱説明書に従って正しい取り扱いをして下さい。



FixYourDIY.com
Sponsored by DM

Discount-Merchant.com (800) 281-8860
THE TRUSTED SOURCE FOR PROJECTOR LAMPS AND ACCESSORIES

regulatory information

xb31

sb21

DECLARATION OF CONFORMITY

According to ISO/IEC Guide 22 and EN 45014

Manufacturer's Name: Hewlett Packard Company

Manufacturer's Address: Hewlett Packard Company
1000 NE Circle Boulevard
Corvallis, OR 97330-4239

Declares, that the product(s):

Product Name: Digital Projector

Model Number(s): xb31, sb21

Product Options: All

Conforms to the following Product Specifications:

Safety: IEC 60950: 1991 + A1, A2, A3, A4 / EN 60950: 1992 + A1, A2, A3, A4, A11, IEC 60825-1: 1993 + A1 / EN 60825-1: 1994 + A11 Class 1 LED

EMC: CISPR 22: 1997 / EN 55022: 1998, Class B [1]
CISPR 24: 1997 / EN 55024: 1998
IEC 61000-3-2: 1995 / EN 61000-3-2: 1995 + A1: 1998 + A2: 1998
IEC 61000-3-3: 1994 / EN 61000-3-3: 1995
FCC Title 47 CFR, Part 15 Class B / ANSI C63.4: 1992

Equipment Class 2: ETS 300-328 Technical requirements for Radio equipment
Notified Body Number: 0682
Notified Body Address: CETECOM ICT Services GmbH,
Untertuerkheimer Str. 6-10, D-66117 Saarbruecken

Supplementary Information:

The product herewith complies with the requirements of the Low Voltage Directive 73/23/EEC, the EMC Directive 89/336/EEC and carries the CE marking accordingly.

The product herewith complies with the requirements of the EMC Directive 89/336/EEC and carries the CE marking accordingly.

This device complies with Part 15 of the FCC Rules. Operation is subject to the following two conditions:
(1) this device may not cause harmful interference, and (2) this device must accept any interference received, including interference that may cause undesired operation.

[1] The product was tested in a typical configuration with Hewlett Packard Personal Computer peripherals.

Corvallis, OR, May 20, 2002

Section manager signature

European Contact: Your local Hewlett Packard Sales and Service Office or
Hewlett Packard GmbH, Department ZQ/Standards Europe, Herrenberger
Strasse 140, D-7030 Boeblingen (FAX: +49-7031-143143).

USA Contact: Hewlett Packard Co., Corporate Product Regulations Manager,
3000 Hanover Street, Palo Alto, CA 94304. Phone: (650) 857-1501.

Reference Safety Information

Laser Safety

The remote controller used with the digital projector is certified as a Class 1 laser device according to the U.S. Department of Health and Human Services (DHHS) Radiation Performance Standard and International Standards IEC 825 / IEC 825-1 (EN 60825 / EN 60825-1). This device is not considered harmful, but the following precautions are recommended:

- Ensure proper use by reading and following the instructions carefully.
- If the unit requires service, contact an authorized hp service center – See page 37 for details.
- Do not attempt to make any adjustment to the unit.
- Avoid direct exposure to the laser beam – do not open the unit.

LED Safety

The infrared port located on the right side of the digital projector is classified as a Class 1 LED (light-emitting diode) device according to International Standard IEC 825-1 (En 60825-1). This device is not considered harmful, but the following precautions are recommended:

- If the unit requires service, contact an authorized hp service center – See page 37 for details.
- Do not attempt to make any adjustment to the unit.
- Avoid direct eye exposure to the infrared LED beam. Be aware that the beam is invisible light and cannot be seen.
- Do not attempt to view the infrared LED beam with any type of optical device.

appendices

Warranty & Support

Refer to warranty/support information data sheet enclosed with the projector or contact hp post-sales support at www.hp.com/support/digitalprojectors or call (in the US) 208-323-2551 or (in Canada) 905-206-4663.

hp offers telephone support world-wide. For the phone number of the customer care center nearest you, please visit the following URL:

http://productfinder.support.hp.com/tps/CLC?h_product=top&h_lang=en&h_region=emea&h_tool=phone

xb31

sb21



Discount-Merchant.com (800) 281-8860
THE TRUSTED SOURCE FOR PROJECTOR LAMPS AND ACCESSORIES



Discount-Merchant.com (800) 281-8860
THE TRUSTED SOURCE FOR PROJECTOR LAMPS AND ACCESSORIES



Disclaimer

This user manual is provided as a free service by FixYourDLP.com. FixYourDLP is in no way responsible for the content of this manual, nor do we guarantee its accuracy. FixYourDLP does not make any claim of copyright and all copyrights remain the property of their respective owners.

About FixYourDLP.com

FixYourDLP.com (<http://www.fixyourdlp.com>) is the World's #1 resource for media product news, reviews, do-it-yourself guides, and manuals.

Informational Blog: <http://www.fixyourdlp.com>

Video Guides: <http://www.fixyourdlp.com/guides>

User Forums: <http://www.fixyourdlp.com/forum>

FixYourDLP's Fight Against Counterfeit Lamps:

<http://www.fixyourdlp.com/counterfeits>

Sponsors:

RecycleYourLamp.org – Free lamp recycling services for used lamps:

<http://www.recycleyourlamp.org>

Lamp Research - The trusted 3rd party lamp research company:

<http://www.lampresearch.com>

Discount-Merchant.com – The worlds largest lamp distributor:

<http://www.discount-merchant.com>



FixYourDLP.com

Sponsored by 